

## NANO SWITCH

5-PORT GIGABIT

### Package Contents

The package contains the items shown below. If any items are missing, please contact the dealer where you purchased this product. The appearance of this product may vary from the illustration.

- 1 pcs Switch
- 1 pcs Power Adapter
- 1 pcs Quick installation Guide

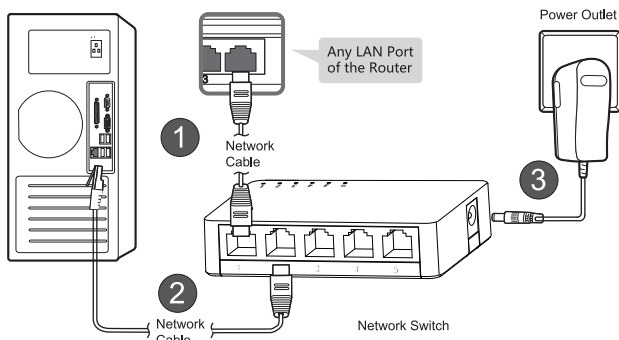

Device Connection Diagram

(The picture is for reference only, please refer to the actual product )

Check whether the connection is correct according to the indicator status in the table below.

LED	Name	Status	Description
PWR	Power Indicator	Always On	Already Power On
1-5Port	Port Indicator	Always On	Port Connected Normally
		Flashing	Port is transmitting data

After the connection is completed correctly, the switch does not require any settings.

### Installation

#### Precautions for Installation

- Do not install the device in an unstable location such as on an unsteady table or an inclined surface.
- Do not place another hub or object that generates heat on this unit.
- Please route all cables properly to prevent people from tripping over them.
- Ensure the air vents on the product are not blocked by other equipment or walls.
- Only use the power cable included with the product. Using other power cables may result in damage or fire.

#### Mounting to a Wall

To mount the unit directly to the wall, use 2 screws (not included) . Install the screws apart and slide the mounting holes on the base of the switch over them.

#### Install on the Desk

Put on the Desk, connect with the Network Cable and the power adapter

### Specifications

Model No.	GLB236050
Interface	5 10/100/1000Mbps RJ45 Ports AUTO Negotiation/AUTO MDI/MDIX
Chip	EN8850
Switching Capacity	10 Gbps
Housing	Plastic housing
Power Input	External Power adapter 5V DC/1A.
LED	Power, 10/100M,1000M, LINK, ACT
Fan	Fanless
Transfer Method	Store and forward
Dimension	Product Size:82.6*48.6*20.5 mm ; Box Size: 90*84*62mm
Weight	Product Weight: 48.5g; Product with Box weight: 135.5g
Advanced Functions	Green Technology, saving power up to 85% 802.3X Flow Control, Back Pressure Auto-Uplink Every Port
Environment	Operating Temperature: 0 C~40 C (32 F~104 F) Storage Temperature: -20 C~70 C (-4 F~158 F) Operating Humidity: 10%~90% non-condensing. Storage Humidity: 5%~90% non-condensing
Package Contents	<ul style="list-style-type: none"> <li>• 5-Port 10/100/1000Mbps Unmanaged Desktop Switch</li> <li>• Plastic housing</li> <li>• Power Adapter</li> </ul>

### Troubleshooting

If you are unable to connect to a network, check the following.

- Is the power cable connected correctly? Also, is the power cable plugged into an outlet or surge protector?
- Is the Ethernet cable connected correctly? Are any cables disconnected?
- Is the link/act/speed LED on? If not, manually set the communication mode of the connected device to 100 Mbps half duplex or 10 Mbps half duplex.

#### IMPORTANT WEEE INFORMATION

This symbol on the product(s) and / or accompanying documents indicates that, under the new Directive 2012/19/EU on waste electrical and electronic equipment (WEEE), product(s) used electrical and electronic equipment (WEEE) should not be mixed with general household waste. For proper treatment, recovery and recycling, please take this product(s) to designated collection points where it will be accepted free of charge.

Disposing of this product correctly will help save valuable resources and prevent any potential negative effects on human health and the environment, which could otherwise arise from inappropriate waste handling.



Please contact your local authority for further details of your nearest designated collection point.  
Penalties may be applicable for incorrect disposal of this waste, in accordance with your national legislation.

For professional users in the European Union  
If you wish to discard electrical and electronic equipment (EEE), please contact your dealer or supplier for further information.

#### WARRANTY

This product is covered by a 2 year warranty, please contact your dealer in case of defects.

Please take care and dispose of this product correctly according to national and local WEEE legislation.

Please note that all names, models and trademarks are the sole property of their respective owners. Gearlab® is a registered trademark of EET Group A/S.

Device composition, specifications and illustration shown on the packaging is for informative purposes only and may differ from the actual product.

Imported into the EU by EET Group A/S  
Tempovej 41, 2750 Ballerup, Denmark

Designed in Denmark  
Made in China